

Flat head square neck bolts with hex nut

BN 280

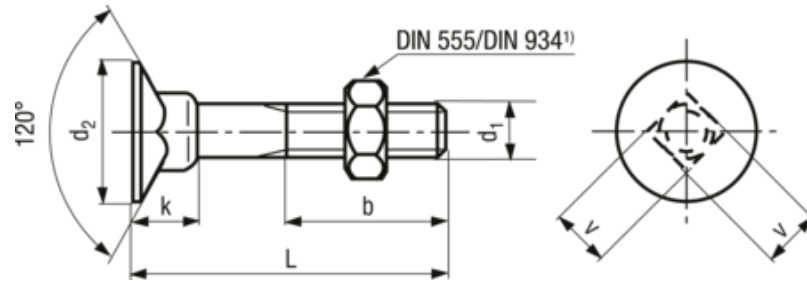

Additional information	At manufacturer's option, the diameter of the shaft may correspond with the pitch diameter
Headform	Countersunk
Thread	partially threaded
Material	Steel
Strength class	4.6 / 4.8 (At manufacturer's option)
Surface	zinc plated blue
Standard	DIN 605 Mu, ~UNI 6104, ~ČSN 021327

1)At manufacturer's option

Article no	d1	L	b	d2 max	k max	v max
1112082	M6	30	18	16.55	7.45	6.48
1112090	M6	35	18	16.55	7.45	6.48
1112104	M6	40	18	16.55	7.45	6.48
1112112	M6	50	18	16.55	7.45	6.48
1112120	M8	30	22	20.65	9.45	8.58
1112139	M8	35	22	20.65	9.45	8.58
1112147	M8	40	22	20.65	9.45	8.58
1112155	M8	50	22	20.65	9.45	8.58
1112163	M8	60	22	20.65	9.45	8.58
1112171	M10	40	26	24.65	11.55	10.58
1112198	M10	50	26	24.65	11.55	10.58
1112201	M10	60	26	24.65	11.55	10.58