

At your service in the field of fastening technology

The company headquartered in Zug, Switzerland, is among the market leaders in fastening technology in Europe, the Americas and Asia-Pacific. Bossard is a global network of companies with **2'500 employees in 77 locations** and carefully selected international partners in all regions of the world.

Our drive for excellence and innovation has led to steady growth and market success for more than 185 years.

The core competences are:



[Product Solutions](#) – the full range of fastening products such as screws, nuts, bolts, woodscrews, washers, pins and much more.



[Assembly Technology Expert](#) and consulting services to optimize your production and assembly processes



[Smart Factory Logistics](#) solutions to free you from C-parts management

BN 4851 3271480 hexalobular socket countersunk flat head screw M5x40

Hexalobular (6 Lobe) socket countersunk flat head screws, fully threaded (ISO 14581), 08.8 / 8.8, zinc plated blue

3D View

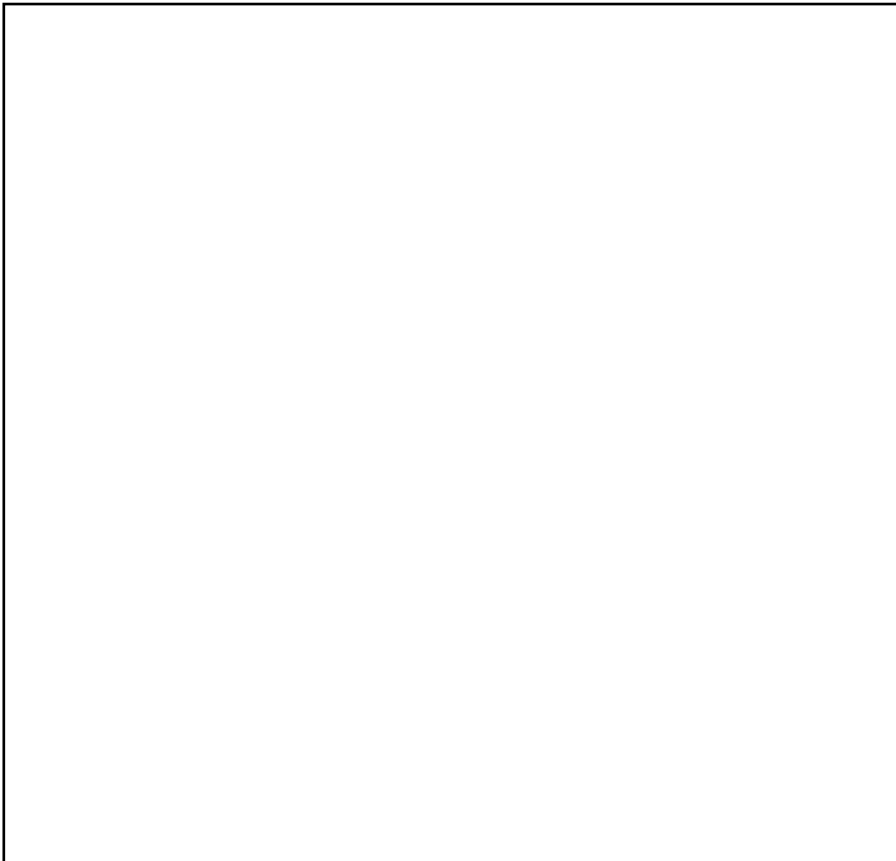

Zoom

Moves you toward or away from objects in the scene when you drag vertically. You can also zoom with the hand tool by holding down Shift as you drag.



Pan

Moves the model vertically and horizontally only. You can also pan with the hand tool: Ctrl-drag.



Rotate

Turns 3D objects around relative to the screen. How the objects move depends on the starting view, where you start dragging and the direction in which you drag.

2D derivation

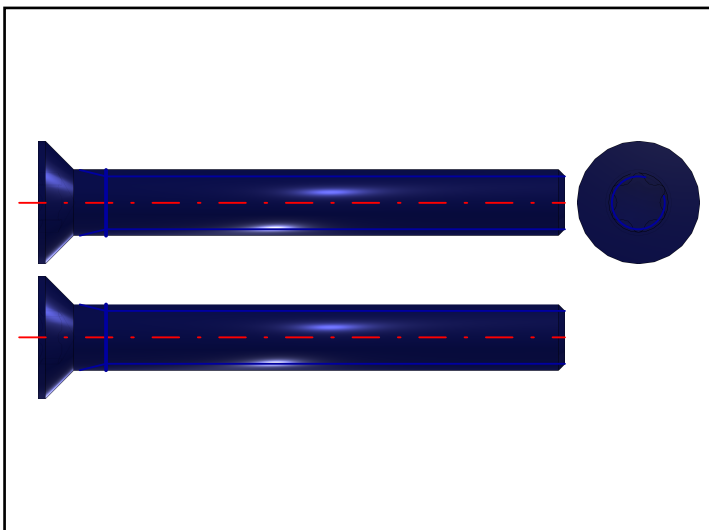

ISO View



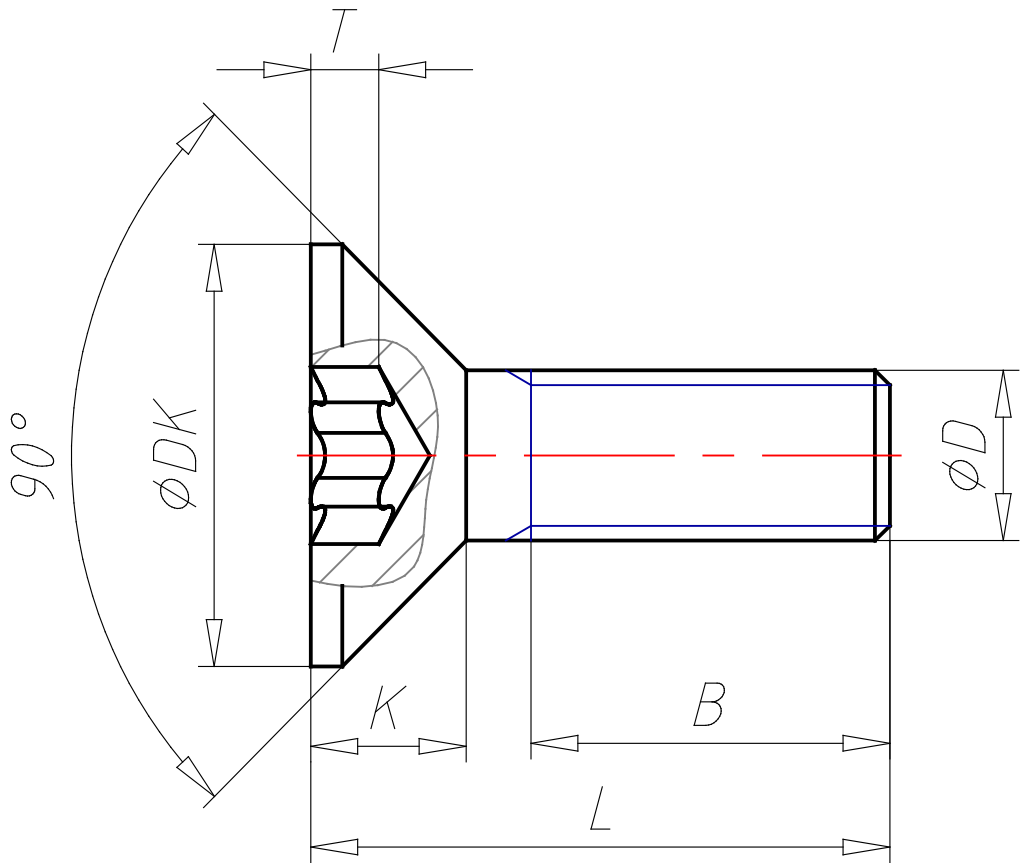

© For this drawing we reserve all rights. Without our permission it may neither be copied nor made accessible to third persons.

© Diese Zeichnung darf ohne unsere schriftliche Genehmigung weder vervielfältigt noch Dritten zugänglich gemacht werden.

	BN 4851 3271480 hexalobular socket countersunk flat head screw M5x40					
	Hexalobular (6 Lobe) socket countersunk flat head screws, fully threaded (ISO 14581), 08.8 / 8.8, zinc plated blue					
Version Index	Modification Aenderung				Date Datum	Changed Geaendert
Comment Bemerkung —						
Specifications and reference standards Technische Lieferbedingungen und Bezugsnormen			Material Werkstoff —			
Tolerances Toleranzen —			Surface Oberflaeche —			
Substitute for Ersatz fuer —			Title Benennung		BOSSARD	
Replaced by Ersetzt durch —						
Drawn Gezeichnet	—	—				
Checked Geprüft	—	—	Drawing no. Zeichnungs-Nr.		Revision Index	Scale Massstab
Approved Freigabe	—	—			—	%

BN 4851 3271480 hexalobular socket countersunk flat head screw M5x40**Hexalobular (6 Lobe) socket countersunk flat head screws, fully threaded (ISO 14581), 08.8 / 8.8, zinc plated blue****Technical Data**

BNARTNR (Identification)	3271480
BNNORM1 ()	ISO 14581
BNMAT (Material)	Steel 08.8 / 8.8
BNSURFACE (Surface)	zinc plated blue
D (Nominal thread diameter / mm)	5
D3 (Core diameter / mm)	4.019
P (Threaded pitch / mm)	0.8
L (Length / mm)	40
B (Thread length / mm)	34.9
DK (Head diameter max. / mm)	9.3
K (Head height / mm)	2.7
NR (Hexalobular socket)	25
A (Torx outer diameter / mm)	4.5
T (Torx-depth max. / mm)	1.51

BN 4851 3271480 hexalobular socket countersunk flat head screw M5x40

Hexalobular (6 Lobe) socket countersunk flat head screws, fully threaded (ISO 14581), 08.8 / 8.8, zinc plated blue

Bill of Materials

N°	Description	Amount
1.1	BN 4851 3271480 hexalobular socket countersunk flat head screw M5x40	1

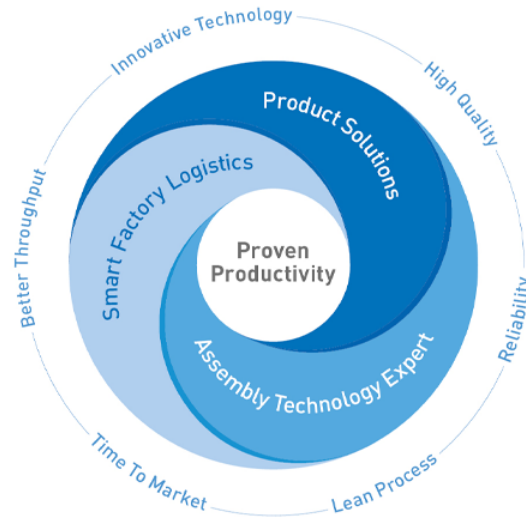

From the perspective of our customers, the interplay has six core benefits within the perspectives of [Product Solutions](#), [Assembly Technology Expert](#) and [Smart Factory Logistics](#):

1. Time to market:

This means that our customers' products are brought to market faster – a crucial competitive advantage in a global environment where speed counts.

2. Lean process:

For our customers, this means saving time, money and resources, being able to better calculate total costs – and above all, achieving higher margins.

3. Better throughput:

This is one of the central cost aspects for our customers when it comes to boosting effectiveness – and especially improving efficiency.

4. High quality:

For our customers, this means absolute reliability in terms of product, process and production safety – and hence, less waste and fewer complaints.

5. Innovative technology:

From a customer's perspective this is crucial. Only companies open to new developments are ready to successfully forge new paths and go where no other competitor has gone before.

6. Maximum reliability:

For our loyal customers, this means knowing that they can rely on us and our long-time employees with the utmost confidence – not just now, but decades down the line.