



X CLOSE

Power Switch > SDDJE Series > SDDJE30400

# 10A 250V AC Qualified Type SDDJE Series

| [Dimensions](#) | [Mounting Hole Dimensions](#) | [Mounting Hole Reference Size](#) |  
| [Circuit Diagram](#) | [Marking \(knob\)](#) | [Packing Specifications](#) | [Soldering Conditions](#) |



Part number [Series Common Info](#)  
**SDDJE30400**

NET SHOP

3D CAD

RoHS

Print

Inquiry

Type	Rocker
Circuit arrangement	DPST
Travel	3.4mm
Operating force	6 ± 3N
Mounting method	Snap-in
Terminal type	Right angle
Frame	With
Marking (knob)	I, O mark
C-UL-US	
SEMKO	

10AGP 250V AC  
6A/96A 250V~, 10(6)/250~

VDE			6A/96A 250V~, 10(6)/250~
BS			6A/96A 250V~, 10(6)/250~
Ratings satisfying local electrical appliance and material safety law			125V 10A $\pm$
Operating temperature range			-10°C to +55°C
Rating			10AGP 250V AC, 6A/96A 250V~
	Contact resistance		100m $\Omega$ max.
Electrical performance	Insulation resistance		500M $\Omega$ min. 500V DC
	Voltage proof		2,000V AC for 1 minute
	Terminal strength		50N for 1 minute (lead terminal) 5N for 1 minute (right-angle terminal)
Mechanical performance		Operating direction	25N
	Actuator strength	Perpendicular direction	25N
Durability	Operating life		10,000 cycles 10A 250V AC
Environmental performance	Cold		-20°C 96h
	Dry heat		85°C 96h
	Damp heat		40°C, 90 to 95%RH 96h
Minimum order unit (pcs.)	Japan	250	
	Export	1,250	

## Dimensions

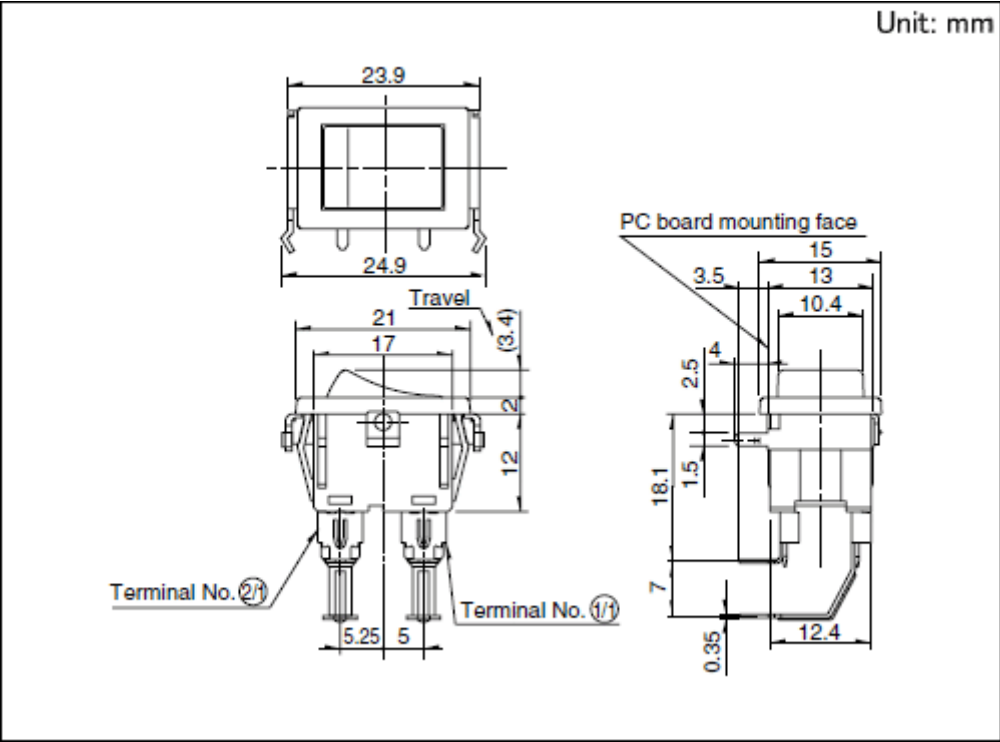

Mounting Hole Dimensions

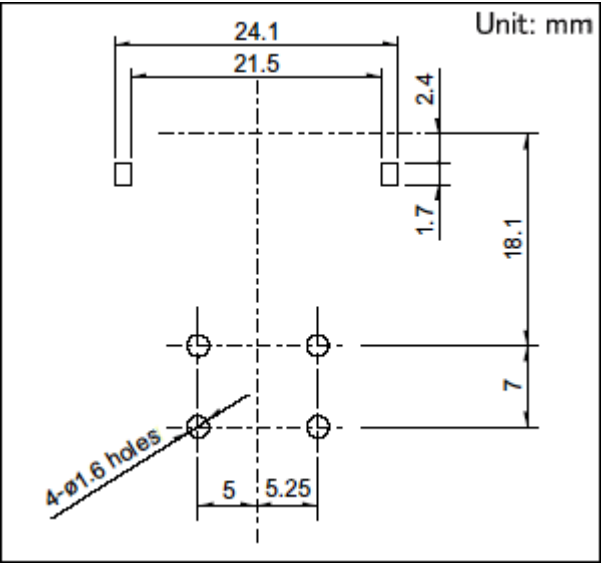

Mounting Hole Reference Size

Square-shaped Hole		Unit:mm
Thickness of mounting board	Y <sub>1</sub>	Z
0.75 to 1.25	19.2 <sup>0</sup> <sub>-0.1</sub>	12.9 <sup>+0.1</sup> <sub>0</sub>
1.25 to 2.00	19.4 <sup>0</sup> <sub>-0.1</sub>	

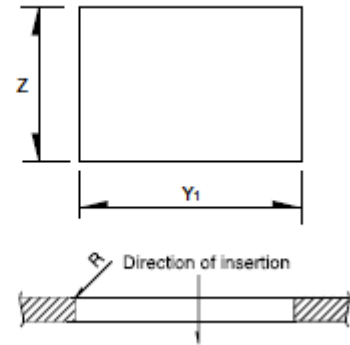

U-shaped Hole		Unit:mm
Thickness of mounting board	Y <sub>2</sub>	Z
0.75 to 1.1	19.5 <sup>0</sup> <sub>-0.1</sub>	12.9 <sup>+0.1</sup> <sub>0</sub>
1.1 to 1.7	19.7 <sup>0</sup> <sub>-0.1</sub>	
1.7 to 2	19.9 <sup>0</sup> <sub>-0.1</sub>	

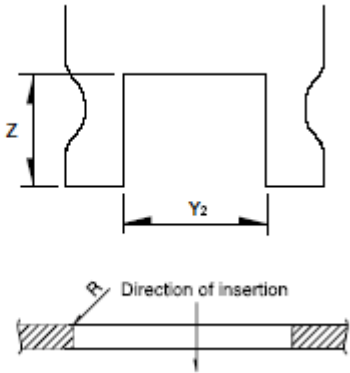

Verify the performance under actual product conditions before use.

Circuit Diagram

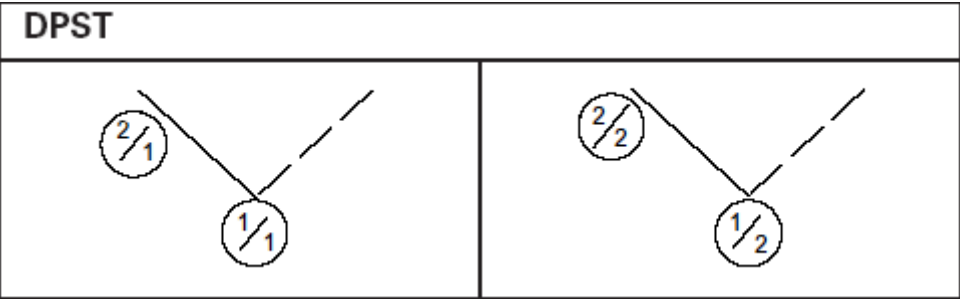

Marking (knob)

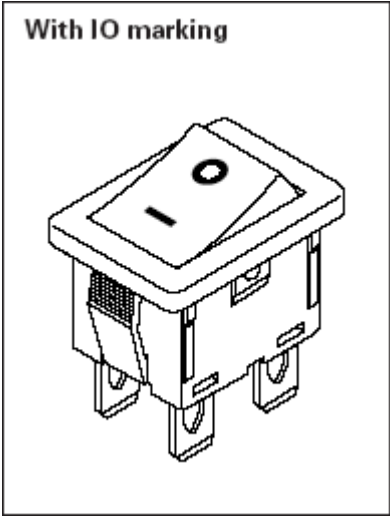

Packing Specifications

Tray

Number of packages (pcs.)	1 case / Japan	250
	1 case / export packing	1,250
	Export package measurements (mm) 411 × 328 × 379	

Soldering Conditions

Reference for Hand Soldering

Soldering temperature	350 ± 10°C
Soldering time	3+1/0s

Notes are common to this series/models.

1. This site catalog shows only outline specifications. When using the products, please obtain formal specifications for supply.
2. The lead terminals are also used as tab terminals (#187). (Use a positive lock connector type.)
3. The lead terminal type can be mounted onto a board. (Manual soldering required.)

4. Standard products apply Grade V-2 material (Flame Class). For Grade V-0 type please contact us.
5. Please place purchase orders per minimum order unit (integer).
6. Products other than those listed in the above chart are also available. Please contact us for details.

## **Inquiries about Products**

[Inquiry.](#)

COPYRIGHT© 2020 ALPS ALPINE CO., LTD