

Technical drawing of a mechanical part, showing a cross-section with a central cylindrical feature and a flange. A dimension line indicates a height of 8,3.

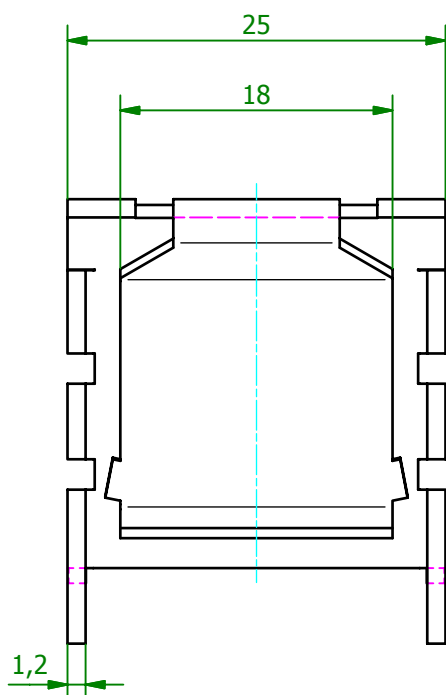
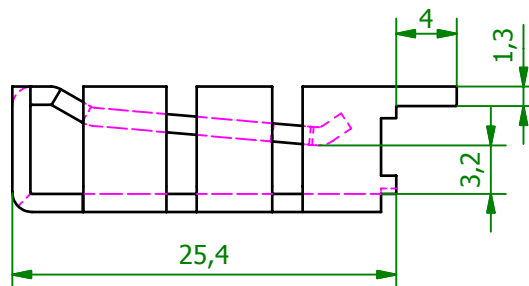

| | | | | | | | |
|--|-------|------|----------------------|------------|------------------------|----------------------------------|---------|
| Schutzvermerk gemäß DIN ISO 16016 beachten © Fischer Elektronik GmbH & Co. KG 2008 | | | Freimasstoleranz | | Oberfläche SA o. MI | Kunde 77777 - Fischer Elektronik | |
| | | | | | | | |
| | | | | Datum | Name | Bezeichnung / Titel | |
| | | | Erst. | 09.06.2009 | Lochen | FK 224 ... P SIP | |
| | | | Bearb. | 13.11.2009 | Lochen | Aufsteckkühlkörper | |
| | | | | | | | |
| | | | | | | | |
| | | | | | | | |
| | | | Werkstoff / Material | | | Zeichnungs-Nummer | Blatt |
| | | | Al99,5 | | | | |
| | | | halbhart | | | | |
| Z. Änderungen | Datum | Name | C001031641.ipt | | | 001031642 | Blätter |
| | | | | | | | 1 |