

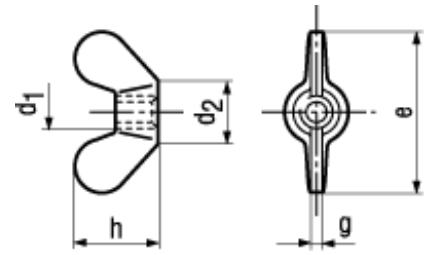

~DIN 315

**BN 525****Dadi ad alette**

Ottone

nichelato

- ~UNI 5448 B
- ~ČSN 021665

Article#	d ₁	d ₂ max.	e max.	h max.	g max.
1197428	M5	11	26	13	2,3
1197436	M6	13	33	17	2,3
1197444	M8	16	39	20	2,8
1197452	M10	20	51	25	4,4
1440284	M12	23	65	33,5	4,9