

Schematic



#### SPECIFICATIONS:

- 1.Switch Rating: DC24V/50mA.
- 2.Mechanical Life:  $\geq 500,000$  cycles.
- 3.Electrical Life:  $\geq 500,000$  cycles.
- 4.Contact Resistance:  $\leq 100\text{m}\Omega$ .
- 5.Insulation Resistance:  $\geq 1,000\text{M}\Omega$ .
- 6.Dielectric Strength: 250V, RMS 50Hz, 1min.
- 7.Operating Temperature:  $-25^{\circ}\text{C} \sim +55^{\circ}\text{C}$  (No Freezing).
- 8.Operating Force: About 3.8N.
- 9.Operating Travel: About 0.5mm.
- 10.Torque: About 0.6Nm max.applied to nut.
- 11.Protection degree: IP65,IK05.

#### MATERIALS:

- 1.Button: Stainless Steel.
- 2.Body: Stainless Steel.
- 3.Base: PA.

FOR  
客户名称

APPROVED  
客户确认签字

ATTN  
销售负责人

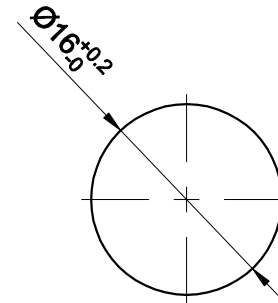

PANEL CUTOUT

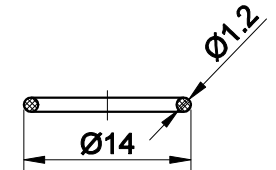

Seal Ring

Part Number:MTA16-10/Y/S

BRAND 品牌		ONPOW		红波按钮制造有限公司 ONPOW PUSH BUTTON MANUFACTURE CO.,LTD.					
THESE DRAWINGS AND SPECIFICATIONS ARE THE PROPERTY OF ONPOW PUSH BUTTON MANUFACTURE CO.,LTD. AND SHALL NOT BE REPRODUCED COPIED OR USED IN ANY MANNER WITHOUT THE PRIOR WRITTEN CONSENT OF ONPOW PUSH BUTTON MANUFACTURE CO.,LTD.				USED 用途		APPD 审核 CH 2020/09/01			
				FINISH 处理		CHKD 校对 NCH 2020/09/01			
				SCALE 1.5 / 1 比例		UNIT mm 单位		DR. 制图 ZPD 2020/09/01	
				DIMENSIONS		TOLERANCE		TITLE 名称	
				0.00 TO 18.00mm		±0.43mm		MTA Series micro travel metal pushbutton	
18.01 TO 30.00mm		±0.52mm		DWG NO. 图号		SIZE 图纸			
30.01 TO 50.00mm		±0.62mm		MTA16-10-Y		A4			
50.01 TO 80.00mm		±0.74mm		FILE NAME 档案名称		SHEET 张			
				MTA16不带灯.DWG		1 / 1			
						REV. 更改			
						1			