

## TOP VIEW OF ASSEMBLY

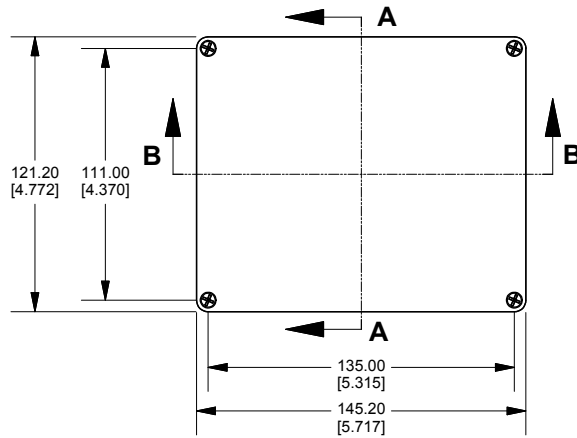

## SECTION A-A END VIEW OF ASSEMBLY

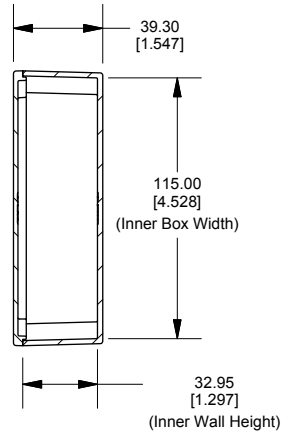

## TOP VIEW LOOKING INSIDE BOX

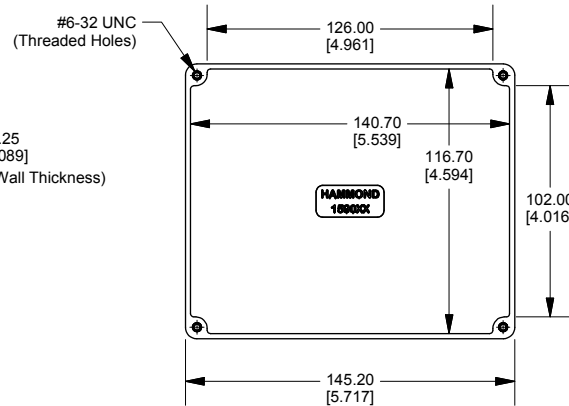

## SECTION B-B SIDE VIEW OF ASSEMBLY

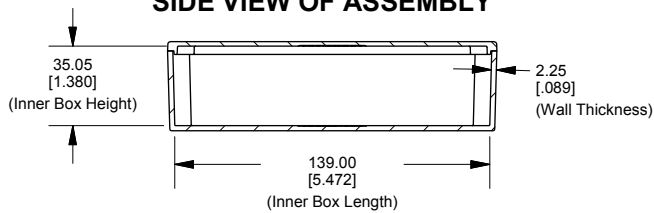

## LID

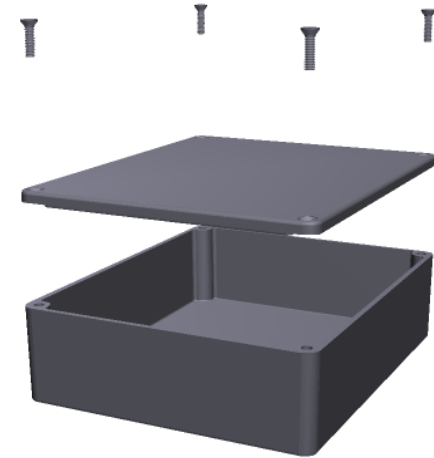
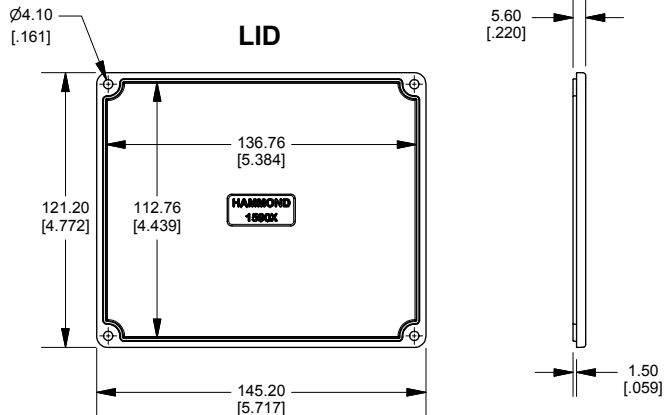

Enclosures can be Factory Modified ( Milling, Drilling, Printing etc.)  
Contact Factory [mjm@hammondmgf.com](mailto:mjm@hammondmgf.com) for quotes  
Solid models of this enclosure available in STEP or IGES.

### NOTE

Purchased assembly includes box, lid and 4 cover screws.  
Box and lid are made from Diecast Aluminum Alloy.  
Silicone Gasket supplied with liquid resistant enclosure.

### PART NUMBERS

1590XX Enclosure	
Natural Finish Enclosure	1590XX
Black Textured Enclosure	1590XXBK
1590XX Liquid Resistant Enclosure (Silicone Gasket)	
Natural Finish Enclosure	1590WXX
Black Textured Enclosure	1590WXXBK

### ACCESSORIES

Recommended Torque: 75 ozf.in / 55 cN.m

### Liquid Resistant Cover Screws

Stainless Steel Cover Screws (Pkg 100) [6-32 x 1/2" With O-Ring]	1590WMS100
Black Stainless Steel Cover Screws (Pkg 100) [6-32 x 1/2" With O-Ring]	1590WMS100BK

### Standard Cover Screws

Plated Cover Screws (Pkg 100) [6-32 x 1/2"]	1590MS100
Black Cover Screws (Pkg 100) [6-32 x 1/2"]	1590MS100BK



**HAMMOND  
MANUFACTURING™**

**1590XX**

[www.hammondmgf.com](http://www.hammondmgf.com)

Dimensions:  
mm  
[inches]