

Spacer bolts with metric threads  
Polyamide

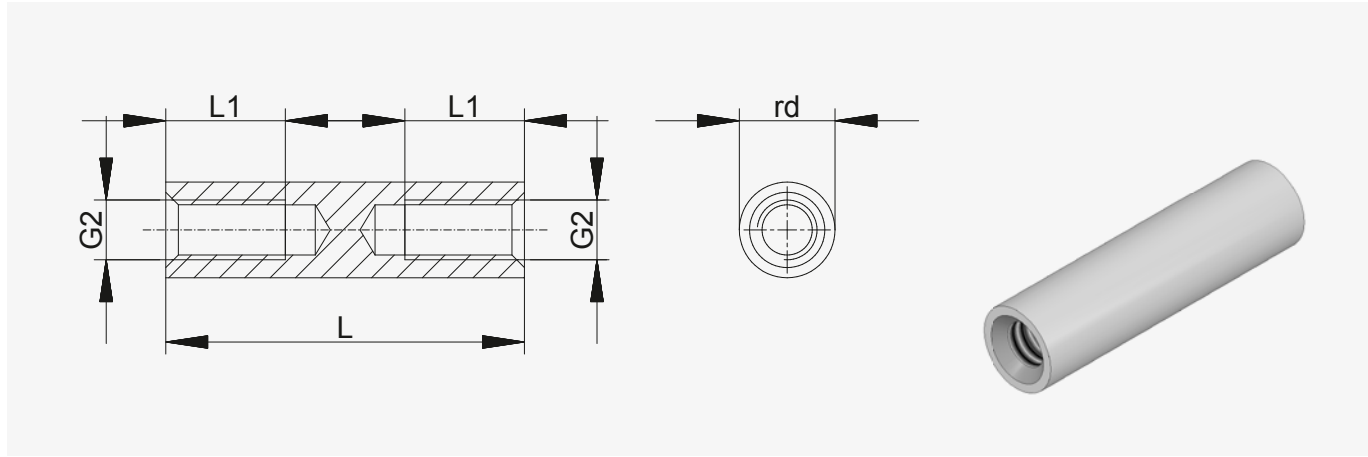

Spacer bolts

**Type** round  
**Design** internal / internal  
**Material** polyamide 6.0 GV\*  
**Colour** black  
**MOQ** 100 pcs

Thread lengths [mm]

| Thread G2 | L (mm)   | L1 (mm)            |
|-----------|----------|--------------------|
| M2 / M2.5 | up to 14 | Full-length thread |
|           | 15-20    | half the lenght    |
|           | from 21  | 10                 |
| M3        | up to 15 | Full-length thread |
|           | 16-20    | half the lenght    |
|           | from 21  | 10                 |
| M4 / M5   | up to 20 | Full-length thread |
|           | from 21  | 10                 |

Contact resistance DIN 53 482: ~ 10<sup>12</sup> Ohm / cm  
Dielectric strength DIN 54 481: 40 kV / mm  
Tolerance for length dimensions: +/- 0.1 mm

| Order number      | Diameter (mm) (rd) | Thread (G2) | Standard lengths in mm (L) |
|-------------------|--------------------|-------------|----------------------------|
| 181 rd x (length) | 4                  | M2          | from 5 mm to 45 mm         |
| 182 rd x          | 5                  | M2.5        | from 4 mm to 55 mm         |
| 185 rd x          | 6                  | M3          | from 5 mm to 60 mm         |
| 187 rd x          | 8                  | M4          | from 5 mm to 65 mm         |

\*GV: glass fiber reinforced  
Order sample: 185rd x 30 = DII / polyamide / rd6 / M3 x 30



Spacer bolts with metric threads  
Brass

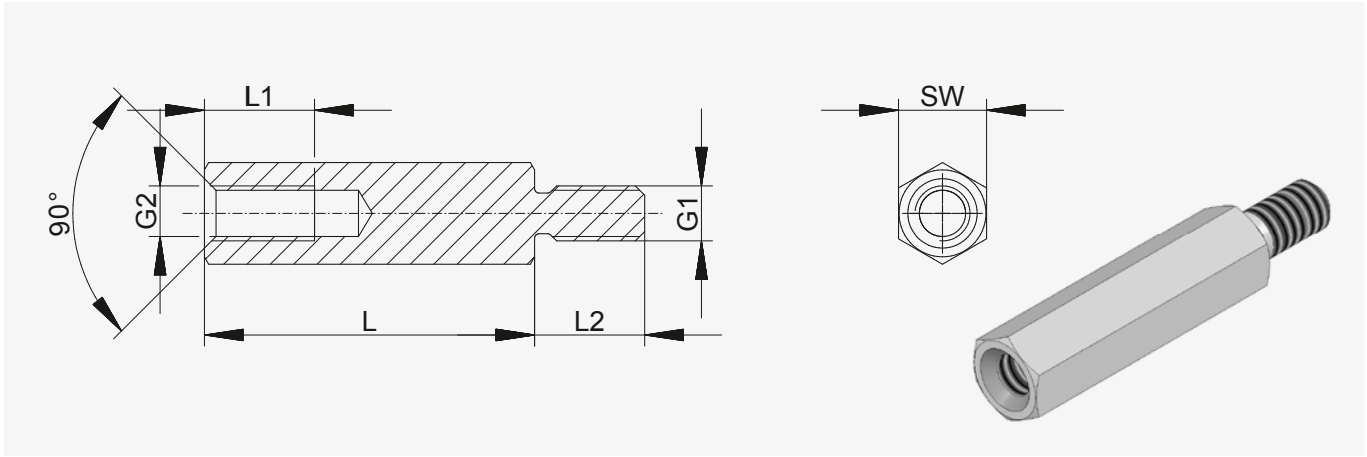

Spacer bolts

**Type** hexagonal  
**Design** internal / external  
with undercut DIN 76-B  
(optional without undercut)  
**Material** brass CuZn39Pb3  
**Colour** nickel-plated (optional uncoated)  
**MOQ** 100 pcs

Internal thread lengths [mm]

| L       | L1 with M2 | L1 with M2.5 to M5 | L1 with M6 | L1 with M8 |
|---------|------------|--------------------|------------|------------|
| 5       | 3          | 3                  |            |            |
| 6       | 4          | 4                  |            |            |
| 8       | 5          | 5                  |            |            |
| 10      | 6          | 6                  | 6          |            |
| 12      | 6          | 7                  | 7          |            |
| 15      | 6          | 10                 | 10         | 10         |
| 18      | 6          | 10                 | 10         | 10         |
| from 20 | 6          | 10                 | 12         | 14         |

External thread lengths [mm]

| G1   | L2    |
|------|-------|
| M2   | 5     |
| M2.5 | 6     |
| M3   | 6*, 8 |
| M4   | 8     |
| M5   | 8     |
| M6   | 10    |
| M8   | 14    |

\* see page 6

Minimum tensile strength: 430 N / mm<sup>2</sup>  
Tolerance for length dimensions: +/- 0.1 mm

| Order number   | Hexagonal size (SW) | Thread (G1/G2) | Standard lengths in mm (L) |    |    |    |    |    |    |    |    |    |    |    |    |    |    |    |    |    |    |    |    |    |    |     |  |  |
|----------------|---------------------|----------------|----------------------------|----|----|----|----|----|----|----|----|----|----|----|----|----|----|----|----|----|----|----|----|----|----|-----|--|--|
| 211 × (length) | SW4                 | M2             | 05                         | 06 | 08 | 10 | 12 | 15 | 18 | 20 | 25 | 30 | 35 | 40 | 45 | 50 |    |    |    |    |    |    |    |    |    |     |  |  |
| 2112 ×         | SW4                 | M2.5           | 05                         | 06 | 08 | 10 | 12 | 15 | 18 | 20 | 25 | 30 | 35 | 40 | 45 | 50 |    |    |    |    |    |    |    |    |    |     |  |  |
| 212 ×          | SW5                 | M2.5           | 05                         | 06 | 08 | 10 | 12 | 15 | 18 | 20 | 25 | 30 | 35 | 40 | 45 | 50 | 55 | 60 |    |    |    |    |    |    |    |     |  |  |
| 213 ×          | SW5                 | M3             | 05                         | 06 | 08 | 10 | 12 | 15 | 18 | 20 | 25 | 30 | 35 | 40 | 45 | 50 | 55 | 60 |    |    |    |    |    |    |    |     |  |  |
| 214 ×          | SW5.5               | M3             | 05                         | 06 | 08 | 10 | 12 | 15 | 18 | 20 | 25 | 30 | 35 | 40 | 45 | 50 | 55 | 60 | 65 | 70 |    |    |    |    |    |     |  |  |
| 215 ×          | SW6                 | M3             | 05                         | 06 | 08 | 10 | 12 | 15 | 18 | 20 | 25 | 30 | 35 | 40 | 45 | 50 | 55 | 60 | 65 | 70 | 75 | 80 | 85 | 90 | 95 | 100 |  |  |
| 216 ×          | SW7                 | M4             | 05                         | 06 | 08 | 10 | 12 | 15 | 18 | 20 | 25 | 30 | 35 | 40 | 45 | 50 | 55 | 60 | 65 | 70 | 75 | 80 | 85 | 90 | 95 | 100 |  |  |
| 218 ×          | SW8                 | M5             |                            |    | 08 | 10 | 12 | 15 | 18 | 20 | 25 | 30 | 35 | 40 | 45 | 50 | 55 | 60 | 65 | 70 | 75 | 80 | 85 | 90 | 95 | 100 |  |  |
| 219 ×          | SW10                | M6             |                            |    |    | 10 | 12 | 15 | 18 | 20 | 25 | 30 | 35 | 40 | 45 | 50 | 55 | 60 | 65 | 70 | 75 | 80 | 85 | 90 | 95 | 100 |  |  |
| 2113 ×         | SW13                | M8             |                            |    |    |    | 15 |    |    | 20 | 25 | 30 | 35 | 40 | 45 | 50 | 55 | 60 | 65 | 70 | 75 | 80 | 85 | 90 | 95 | 100 |  |  |

Order sample: 211 x 10 = DIA / brass / SW4 / M2 x 10

