

Spacer bolts with metric threads
Aluminium

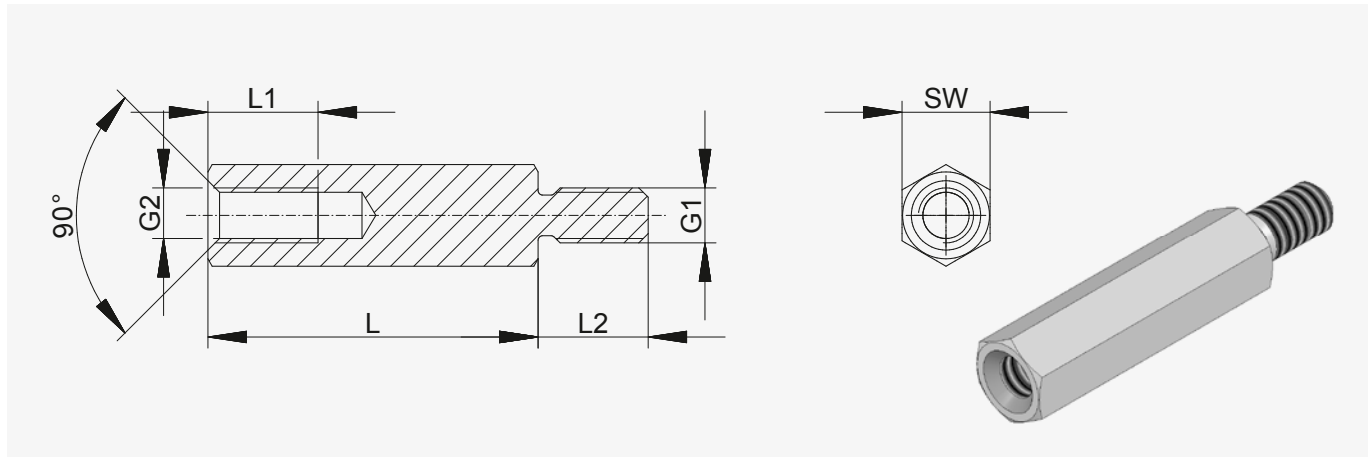

Spacer bolts

Type	hexagonal
Design	internal / external with undercut DIN 76-B (optional without undercut)
Material	aluminium AlCuBiPb
Surface	uncoated
MOQ	100 pcs

Internal thread lengths [mm]

L	L2 with M2.5 to M3	L2 with M4	L2 with M5	L2 with M6	L2 with M8
5	2.5				
8	5	5			
10	6	6	6	5	
12	7	8	8	7	
15	7	9	10	10	10
18	7	9	10	12	12
from 20	7	9	10	12	14

External thread lengths [mm]

G1	L2
M2.5	6
M3	6
M4	8
M5	8
M6	10
M8	14

Minimum tensile strength: 310 N / mm²
Tolerance for length dimensions: +/- 0.1 mm
(DIN 2678-m applies for SW13)

Order number	Hexagonal size (SW)	Thread (G1/G2)	Standard lengths in mm (L)																	
232 x (length)	SW5	M2.5	05	08	10	12	15	18	20	25	30	35	40	45	50	55	60			
234 x	SW5.5	M3	05	08	10	12	15	18	20	25	30	35	40	45	50	55	60			
235 x	SW6	M3	05	08	10	12	15	18	20	25	30	35	40	45	50	55	60	65	70	
236 x	SW7	M4	05	08	10	12	15	18	20	25	30	35	40	45	50	55	60	65	70	75
238 x	SW8	M5		08	10	12	15	18	20	25	30	35	40	45	50	55	60	65	70	75
239 x	SW10	M6			10	12	15	18	20	25	30	35	40	45	50	55	60	65	70	75
2313 x	SW13	M8				15		20	25	30	35	40	45	50		60	70	80	90	100

Order sample: 236 x 50 = DIA / aluminium / SW7 / M4 x 50



Spacer bolts with metric threads
Stainless steel

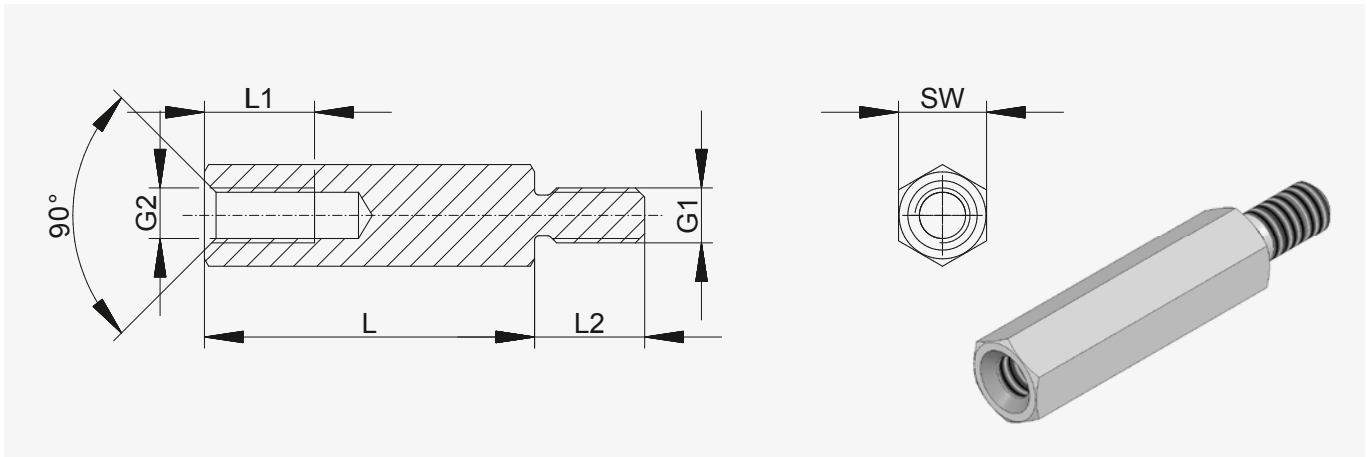

Spacer bolts

Type	hexagonal
Design	internal / external with undercut DIN 76-B (optional without undercut)
Material	stainless steel 1.4305
Surface	uncoated
MOQ	100 pcs

Internal thread lengths [mm]

L	L1 with M2	L1 with M2.5 to M3	L1 with M4	L1 with M5	L1 with M6	L1 with M8
5	2.5	2.5				
8	5	5	5			
10	6	6	6	6	5	
12	6	7	8	8	7	
15	6	7	9	10	10	10
18	6	7	9	10	12	12
from 20	6	7	9	10	12	14

External thread lengths [mm]

G1	L2
M2	5
M2.5	6
M3	6
M4	8
M5	8
M6	10
M8	14

Minimum tensile strength: 750 N / mm²
Tolerance for length dimensions: +/- 0.1 mm
(DIN 2678-m applies for SW13)

Order number	Hexagonal size (SW)	Thread (G1/G2)	Standard lengths in mm (L)																	
241 x (length)	SW5	M2	05	08	10	12	15	18	20	25	30	35	40	45	50	55	60			
242 x	SW5	M2.5	05	08	10	12	15	18	20	25	30	35	40	45	50	55	60			
244 x	SW5.5	M3	05	08	10	12	15	18	20	25	30	35	40	45	50	55	60	65	70	
246 x	SW7	M4		08	10	12	15	18	20	25	30	35	40	45	50	55	60	65	70	75
248 x	SW8	M5			10	12	15	18	20	25	30	35	40	45	50	55	60	65	70	75
249 x	SW10	M6			10	12	15	18	20	25	30	35	40	45	50	55	60	65	70	75
2413 x	SW13	M8				15		20	25	30	35	40	45	50		60	70	80	90	100

Order sample: 246 x 50 = DIA / stainless steel / SW7 / M4 x 50

