

At your service in the field of fastening technology

The company headquartered in Zug, Switzerland, is among the market leaders in fastening technology in Europe, the Americas and Asia-Pacific. Bossard is a global network of companies with **2'500 employees in 77 locations** and carefully selected international partners in all regions of the world.

Our drive for excellence and innovation has led to steady growth and market success for more than 185 years.

The core competences are:



[Product Solutions](#) – the full range of fastening products such as screws, nuts, bolts, woodscrews, washers, pins and much more.



[Assembly Technology Expert](#) and consulting services to optimize your production and assembly processes



[Smart Factory Logistics](#) solutions to free you from C-parts management

BN 33032 5816010 hexagon socket set screw M5x25

Hex socket set screws with cone point (ISO 4027; DIN 914), A4, stainless steel A4

3D View**Zoom**

Moves you toward or away from objects in the scene when you drag vertically. You can also zoom with the hand tool by holding down Shift as you drag.

**Pan**

Moves the model vertically and horizontally only. You can also pan with the hand tool: Ctrl-drag.

**Rotate**

Turns 3D objects around relative to the screen. How the objects move depends on the starting view, where you start dragging and the direction in which you drag.

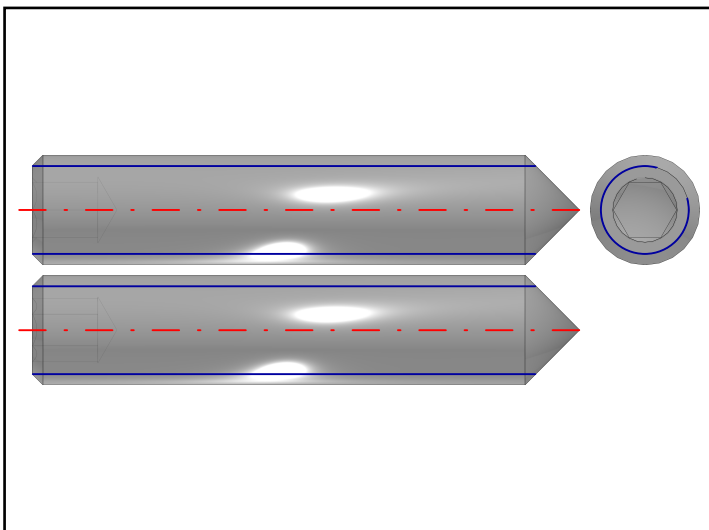
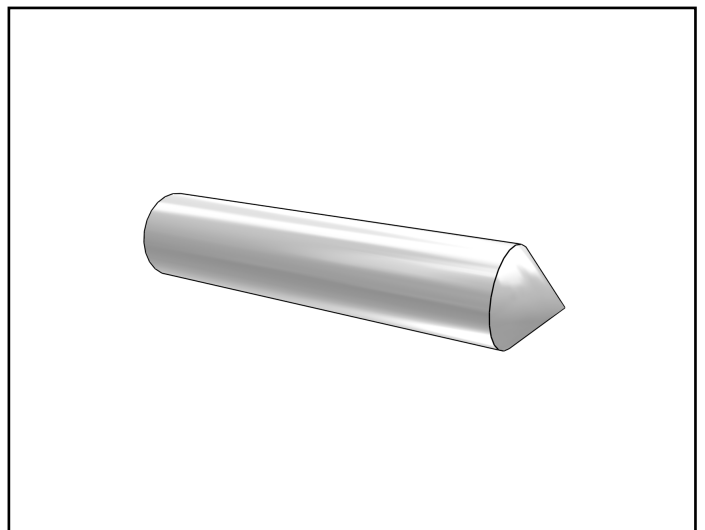
2D derivation**ISO View**

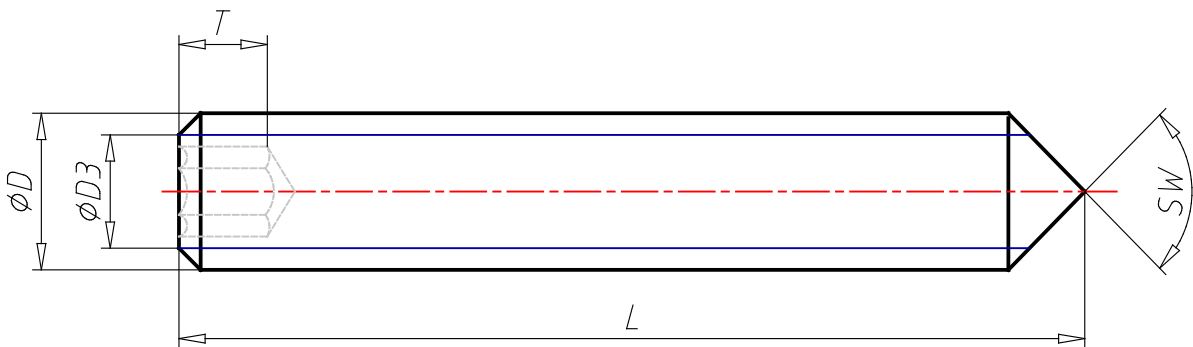

© For this drawing we reserve all rights. Without our permission it may neither be copied nor made accessible to third persons.

© Diese Zeichnung darf ohne unsere schriftliche Genehmigung weder vervielfältigt noch Dritten zugänglich gemacht werden.

	BN 33032 5816010 hexagon socket set screw M5x25				
	Hex socket set screws with cone point (ISO 4027; DIN 914), A4, stainless steel A4				
Version Index	Modification Aenderung			Date Datum	Changed Geaendert
Comment Bemerkung —					
Specifications and reference standards Technische Lieferbedingungen und Bezugsnormen		Material Werkstoff			
—		—			
Tolerances Toleranzen		Surface Oberflaeche			
—		—			
Substitute for Ersatz fuer —		Title Benennung		BOSSARD	
Replaced by Ersetzt durch —					
Drawn Gezeichnet	—			—	Dimensions Dimensionen mm
Checked Geprueft	—	—	Drawing no. Zeichnungs-Nr.	Revision Index	Scale Massstab
Approved Freigabe	—	—		—	%

BN 33032 5816010 hexagon socket set screw M5x25**Hex socket set screws with cone point (ISO 4027; DIN 914), A4, stainless steel A4****Technical Data**

BNARTNR (Identification)	5816010
BNNORM1 ()	ISO 4027
BNNORM2 ()	DIN 914
BNMAT (Material)	Stainless steel A4
D (Nominal thread diameter / mm)	5
D3 (Thread core diameter / mm)	4.019
P (Threaded pitch / mm)	0.8
L (Nominal length / mm)	25
DT (Diameter of the truncated cone point max. / mm)	0
E (Width across corners min. / mm)	2.87
S (Width across flats / mm)	2.5
T (Depth of the driving feature min. / mm)	3
SW (Angle of the cone / °)	90

BN 33032 5816010 hexagon socket set screw M5x25

Hex socket set screws with cone point (ISO 4027; DIN 914), A4, stainless steel A4

Bill of Materials

N°	Description	Amount
1.1	BN 33032 5816010 hexagon socket set screw M5x25	1

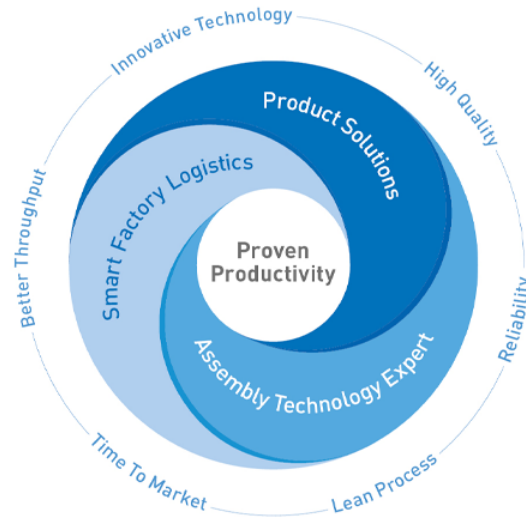

From the perspective of our customers, the interplay has six core benefits within the perspectives of [Product Solutions](#), [Assembly Technology Expert](#) and [Smart Factory Logistics](#):

1. Time to market:

This means that our customers' products are brought to market faster – a crucial competitive advantage in a global environment where speed counts.

2. Lean process:

For our customers, this means saving time, money and resources, being able to better calculate total costs – and above all, achieving higher margins.

3. Better throughput:

This is one of the central cost aspects for our customers when it comes to boosting effectiveness – and especially improving efficiency.

4. High quality:

For our customers, this means absolute reliability in terms of product, process and production safety – and hence, less waste and fewer complaints.

5. Innovative technology:

From a customer's perspective this is crucial. Only companies open to new developments are ready to successfully forge new paths and go where no other competitor has gone before.

6. Maximum reliability:

For our loyal customers, this means knowing that they can rely on us and our long-time employees with the utmost confidence – not just now, but decades down the line.