

Rating	20A 12V DC	<div>Mounting Hole</div> 	<div>Circuit Diagram</div>  <p>12V LED</p> <p>R=680Ω</p>											
Contact Resistance	50m ohm Max													
Insulation Resistance	DC 500V 100M ohm Min													
Dielectric Strength	AC 1500V 1 minute													
Operation Temperature	-25°C~85°C													
Switch Function	3P SPST ON-OFF(LED)	<table><tr><th>Thickness</th><th>X</th><th>Y</th></tr><tr><td>0.75...1.25</td><td>19.2-0.1</td><td>13±0.1</td></tr><tr><td>1.25...2</td><td>19.4-0.1</td><td>13±0.1</td></tr><tr><td>2...3</td><td>19.8-0.1</td><td>13±0.1</td></tr></table>	Thickness	X	Y	0.75...1.25	19.2-0.1	13±0.1	1.25...2	19.4-0.1	13±0.1	2...3	19.8-0.1	13±0.1
Thickness	X	Y												
0.75...1.25	19.2-0.1	13±0.1												
1.25...2	19.4-0.1	13±0.1												
2...3	19.8-0.1	13±0.1												

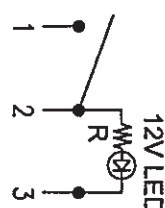

Material:  
Frame: Black, Nylon 66  
Actuator: Black, Nylon66  
Lens: Red, PC  
LED: Red

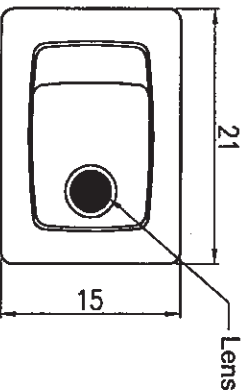
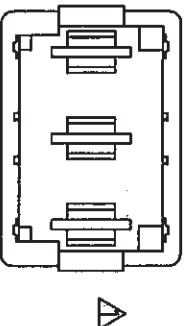
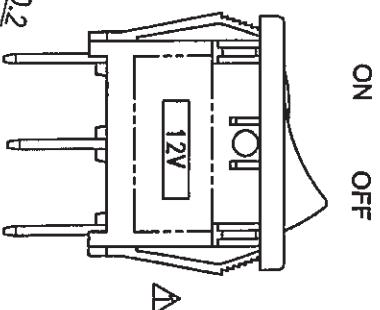
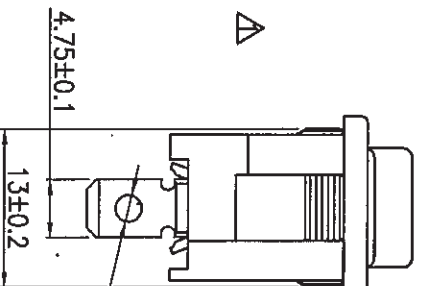
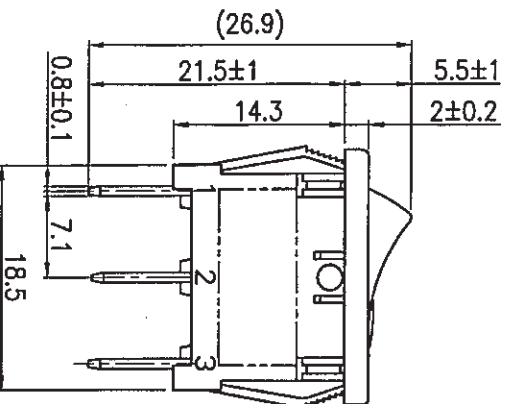

Tolerances Unless Otherwise Specified ±0.3

08/09/11	雷云飛	Remove the UL mark.			△
Date	Name	Description			No. △
Drawn	Checked	Approved	SCI BOM No.	1821423	Model Name ROCKER SWITCH
雷云飛	12/14/11	12/14/11	Customer No.		Model No. R13-66B2-02
08/09/11	12/15/11	12/15/11	Unit	mm	Rev. 1
			Shin Chin Industrial Co., Ltd.		

12/15/11